

X

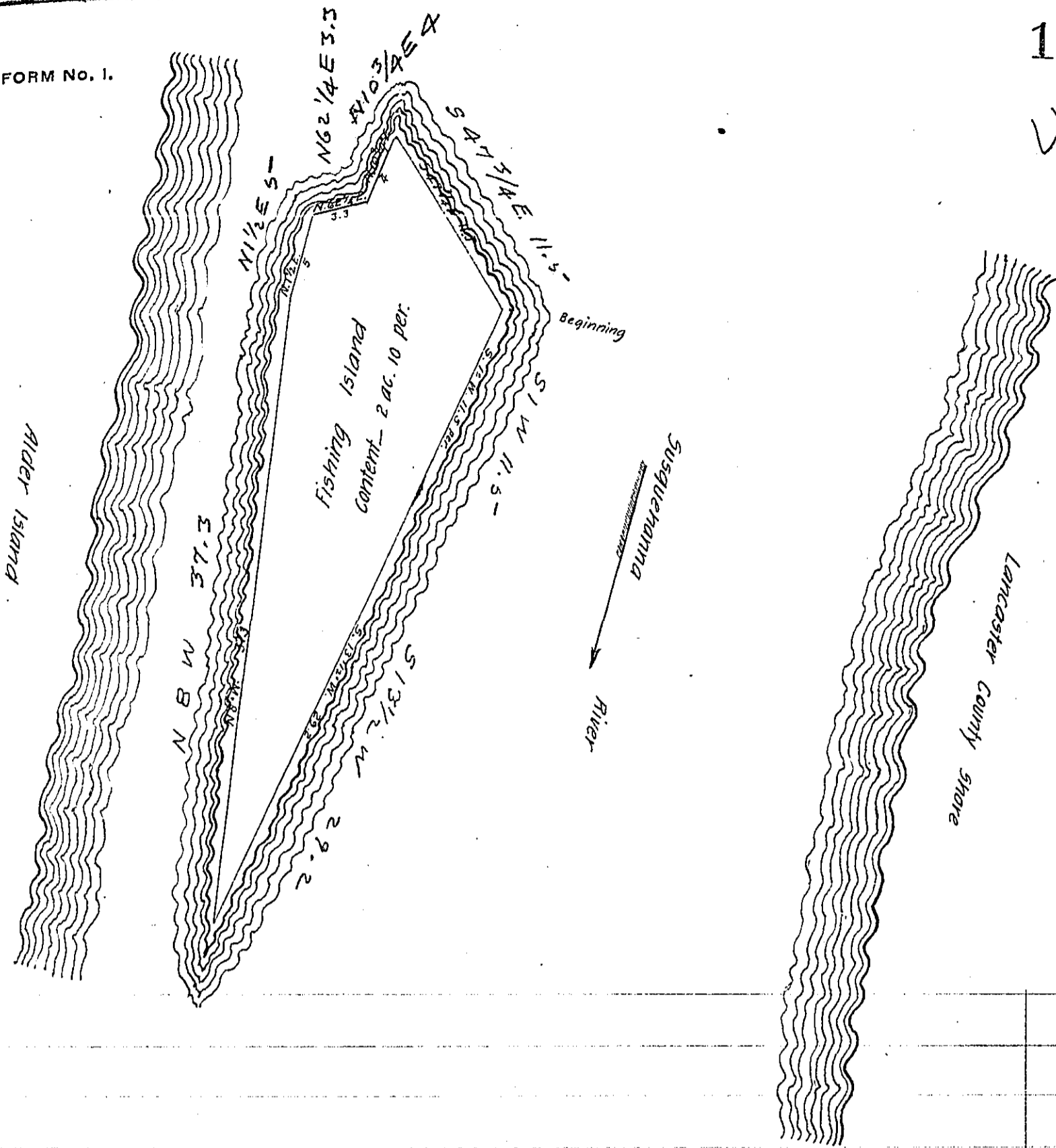

A Draught of Fishing Island. Situate in Martie township Lancaster County in the River Susquehanna, between the shores of M^c Creary's land and Alder Island, containing Two acres and ten perches neat measure. Surveyed December 17th 1855 in pursuance of a Warrant granted to Isaac Mundorff the 21st day of May A D 1835

by Casper Hiller
for
Isaac Hoffer

County Surveyor

Approved January 16th 1856

Isaac Hoffer

IN TESTIMONY that the above is a copy of the original remaining on file in the Department of Internal Affairs of Pennsylvania, made conformably to an Act of Assembly approved the 16th day of February, 1833, I have hereunto set my Hand and caused the Seal of said Department to be affixed at Harrisburg, this first day of May 1906

Isaac Hoffer
Secretary of Internal Affairs.